

DISTRIBUTED BY
COLTERLEC™

TROAX®

MAKING YOUR WORLD SAFE

- » **MACHINE GUARDING**
- » **INDUSTRIAL SAFETY FENCING**
- » **WAREHOUSE PARTITIONING**
- » **PALLET BACK MESH SYSTEMS**
- » **SERVER ROOM PARTITIONING**
- » **QUICKGUARD ALUMINIUM**
- » **BLUEGUARD STAINLESS STEEL**
- » **D-FLEXX IMPACT BARRIERS**

PROTECTING PEOPLE, PROPERTY, AND PROCESSES.

MODERN MODULAR SAFETY SYSTEMS
EASY TO INSTALL
FREE DESIGN SERVICE
COLOUR CUSTOMISATION



Type Approved
Safety
Regular Production
Surveillance



www.tuv.com
ID 1111214984

MACHINE GUARDING / INDUSTRIAL SAFETY FENCING



We offer a complete range of machine guarding solutions to protect both personnel and processes. Our modular guarding systems can be combined and adapted to fit your specific needs.

We offer a range of flexible and modular protective wall systems for any type of production environment.

- » Modular, easy to install systems
- » Mesh, steel and polycarbonate panels
- » Standard or customized colours
- » Smart Fix, Strong Fix or Rapid Fix systems for easy access
- » TUV certified tested to withstand up to 2,500 joules impacts
- » Hinged, Sliding, Telescopic, Linear and Power Door options
- » Safety Locks for all safety performance levels

WIDE RANGE OF SMART ACCESSORIES

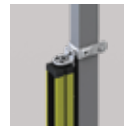

Light Curtain Brackets



Smart Post



Safe Lock

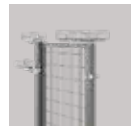

Wire Trays

WAREHOUSE PARTITIONING

TROAX offers complete solutions for your entire logistics flow. Our warehouse partitioning solutions will make your material handling both safer and more efficient.

Protection solutions for conventional and automated logistics, such as storage cages, warehouse partitioning, and anti-collapse systems for pallet racks.

- » Tailor made solutions
- » Innovative, cost effective, flexible
- » Wide range of mesh and solid steel panels to suit all needs
- » Many different door and locking solutions
- » Partition wall panels
- » Aerosal storage
- » Mezzanine guard system
- » Unique pallet back mesh system



Mezzanine



Aerosal Storage



Pallet Back Mesh



Property Storage



Troax Cage

D-FLEXX - IMPACT PROTECTION BARRIERS

D-Flexx is a safety barrier system and offers impact protection made from flexible polyethylene for indoor and outdoor use.

- » TUV Tested
- » UV protected for indoor and outdoor use
- » Easy Installation
- » all mounting equipment included
- » Reduces repair and maintenance costs
- » Versatile -suitable for production, warehouse or logistical areas
- » Ideal for pedestrian safety and traffic management



DESIGN AND VIEW YOUR TROAX SOLUTION BEFORE ORDERING

JUST DRAWIT

Draw it yourself with our free online software tool. Troax Drawit is a new and easy tool for you to create the ideal solution. No software required, and just three easy steps from idea to quotation.

Or simply send us your drawing, layout, sketch or dimensions and we will design a complete layout to suit your requirements.

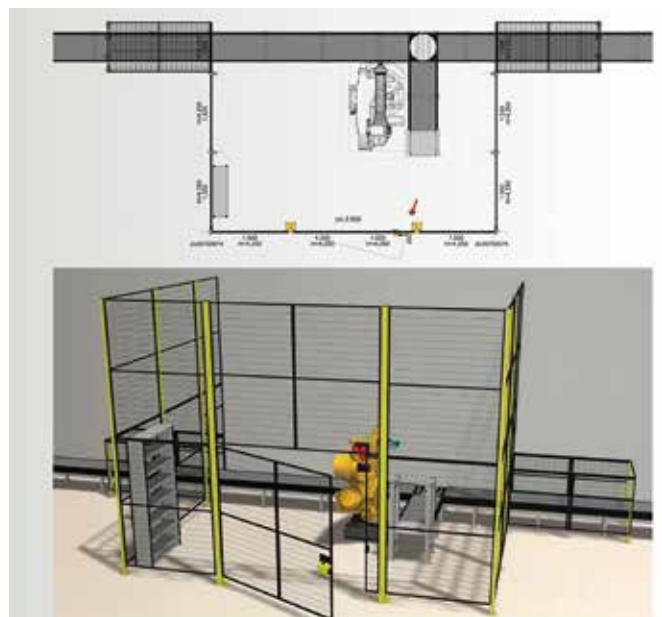

DATA CENTER-SERVER ROOM PARTITIONING

- » A Cost-effective And Flexible Solution.
- » Adaptable To Fit Any Height And Can Be Combined With Our Mesh Ceilings.
- » Allows Proper Air Circulation, Light And Sprinkler Penetration.



Our modular panel systems – with or without mesh ceilings – can be adapted to fit any height.

The mesh panels allow proper air circulation and can be built around existing installations and obstacles. Our offer includes mesh or steel sheet panels. The latter are primarily used to protect an area from view.

There are several solutions to provide a proper floor environment for computers and servers, as well as solutions to protect the area above a suspended ceiling.



202204-4107-EN