

TECHNICAL DATA

Fluke 835 Laser belt alignment tool

Get more out of your belt driven systems through proper alignment

EASY TO USE

- Quick, simple, complete pulley alignment. No training required
- Efficient one-person operation

PRECISE

- Reflected laser technology doubles the distance, enhancing accuracy

LIGHT, ROBUST, RUGGED

- A small tool in your bag to take anywhere

UNIQUE DESIGN

- No small parts
- Strong magnets mount to any size pulley or sprocket

It is a known fact that all rotating machinery are susceptible to misalignment. An aligned pulley system reduces belt wear, power losses, and vibration of machinery, leading to improved performance.

You could be losing thousands of dollars per year in replacement bearing and belt costs, hours of unnecessary repair time, and crippling unplanned downtime, not to mention taking years off your machine's useful life.

How Fluke 835 provides fast, easy, accurate pulley alignments:

- Tailor-made for pulley alignment jobs, easy to use and only requires a single operator.
- The strong magnets on the two units mount onto virtually any pulley face, making it the ideal partner for most pulley alignment jobs.
- Leverages the proven OPTALIGN® reflected beam principle for maximum angular resolution to generate accurate and reliable readings.
- Time-saving method requires no cross-checking and shows offset, vertical, and horizontal angle simultaneously.
- The Fluke 835 provides 6 hours of continuous use.
- Corrections are quickly made live and genuine alignment is achieved when the transmitted laser line and the corresponding reflected laser line harmonise with the respective reference line.



Alignment of belt pulleys in four simple steps

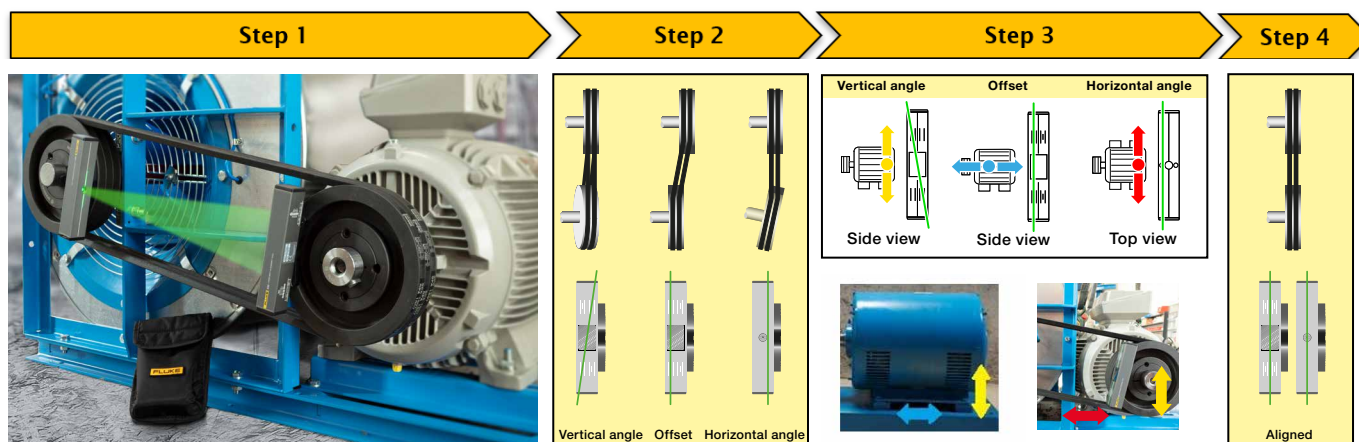

1. Initiate the Fluke 835 laser and mount the units on the faces to be aligned. The reflector should be mounted onto the machine to be moved (motor) while the laser transmitter is mounted on the stationary (driven) component.
2. The position of the transmitted laser line on the reflector indicates vertical angularity and offset. Horizontal angularity is indicated by the position of the reflected laser line on the transmitter.
3. Make adjustments while observing the laser lines on the reflector and the laser units:
 - Correct vertical angularity by shimming moveable machine observing the correction on the reflector.
 - Correct offset by shifting moveable machine axially observing the reflector unit.
 - Correct horizontal angularity by shifting moveable machine horizontally observing correction on the laser unit.
4. Genuine alignment is achieved when the transmitted laser line and the corresponding reflected laser line harmonise with their respective reference lines.

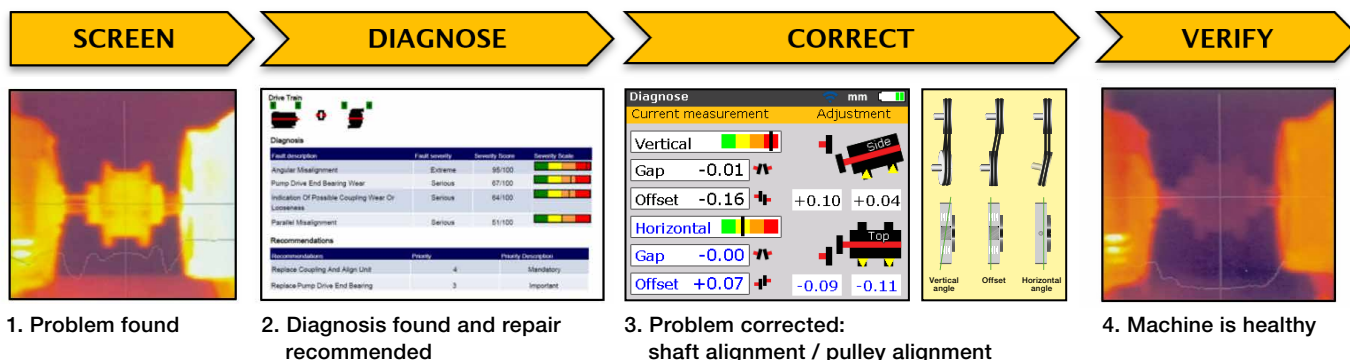

Fluke tools help keep your plant up and running

Fluke offers a complete line of predictive maintenance tools designed to help maximise plant uptime. Whether you are using a Fluke vibration analyser to diagnose fault and severity, or a Fluke thermal imager to evaluate machine health, Fluke tools help reduce production gaps and lower maintenance repair costs.

Fluke tools work together to solve complicated problems, for example: A Fluke Vibration Meter or Thermal Imager will help you identify a malfunctioning machine, while a Fluke Vibration Analyser can help you diagnose the issue. A Fluke Shaft Alignment tool can then help you correct shaft misalignment, and the **Fluke 835** addresses belt misalignment. Finally, a Fluke Vibration Meter or Thermal Imager lets you verify that your machine can pass which a clean bill of health.

Ordering Information

Fluke 835, Laser Belt Alignment Tool

Includes:

Fluke 835 laser unit (green laser), 4 batteries (AAA), **Fluke 835** reflector unit, fabric carrying pouch, safety info, Quick Reference Guide



Fluke 835 laser

General specifications

Accuracy	0.2°
Laser wavelength	505 - 535 nm (green – more visible)
Output power	< 1.0 mW
Classification class	2
Measuring distance	10 m between units
Laser line length	7 m at 5 m distance
Controls	Laser ON/OFF rocker switch
Battery type	4 AAA alkaline batteries
Operating time	6 hours
Operating temp	-5°C to 40°C
Storage temp	-10°C to 70°C
Mounting method	Strong magnets
Weight	0.3 kg
Dimensions	37 x 40 x 170 mm
Housing	Gray anodised aluminum

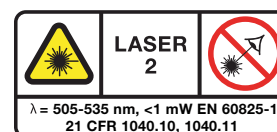
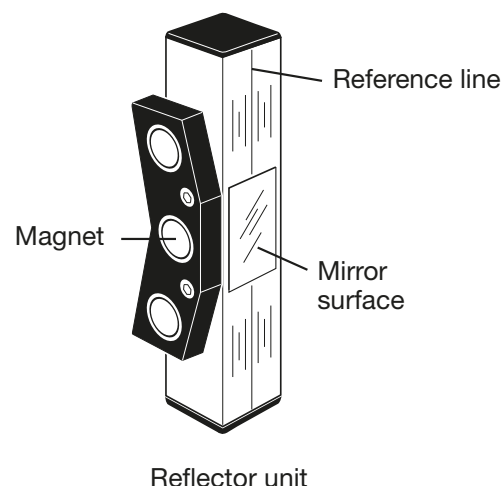
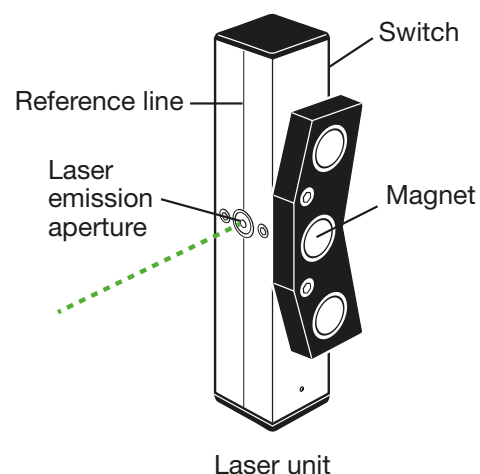

Fluke. Keeping your world up and running.®

©2022 Fluke Corporation.
Specifications subject to change without notice.
7/20222 220450-en

Modification of this document is not permitted without written permission from Fluke Corporation.

